

# 12

## A

# JAMES BOYER MICHAEL HORA

LOCATION	PERSONNEL	CLASS	TRUCK NUMBER	CELL NO.	MISC. EQUIPMENT
Site 12 Exit 83 CR-6	AARON ANDERSON	TMT III-CL	ST-15838 CREWCAB	U	TM/ARW BRD, W/TLR ST-17510
	BRENDA STALLWORTH	TT	PICKUP		
	SIERRA TAYLOR	EA I			
	JUSTIN BOOKER	TMT I	ST-18951 PICKUP		

22	<b>MOBILE AREA IN PLACE PERSONNEL</b>
23	<b>TL/ATL IN PLACE</b>
26	<b>READY TO IMPLEMENT</b>
30	<b>NOTIFY TL TO PROCEEDURE</b>
46	<b>SB ATL PASSED</b>
57	<b>ATL'S NB HAVE PASSED</b>
59	<b>INTERCHANGE CLEAR</b>
67	<b>TRAFFIC REVERSED 1ST WAVE</b>
80	<b>1ST WAVE</b>
104	<b>TRAFFIC NORMAL</b>

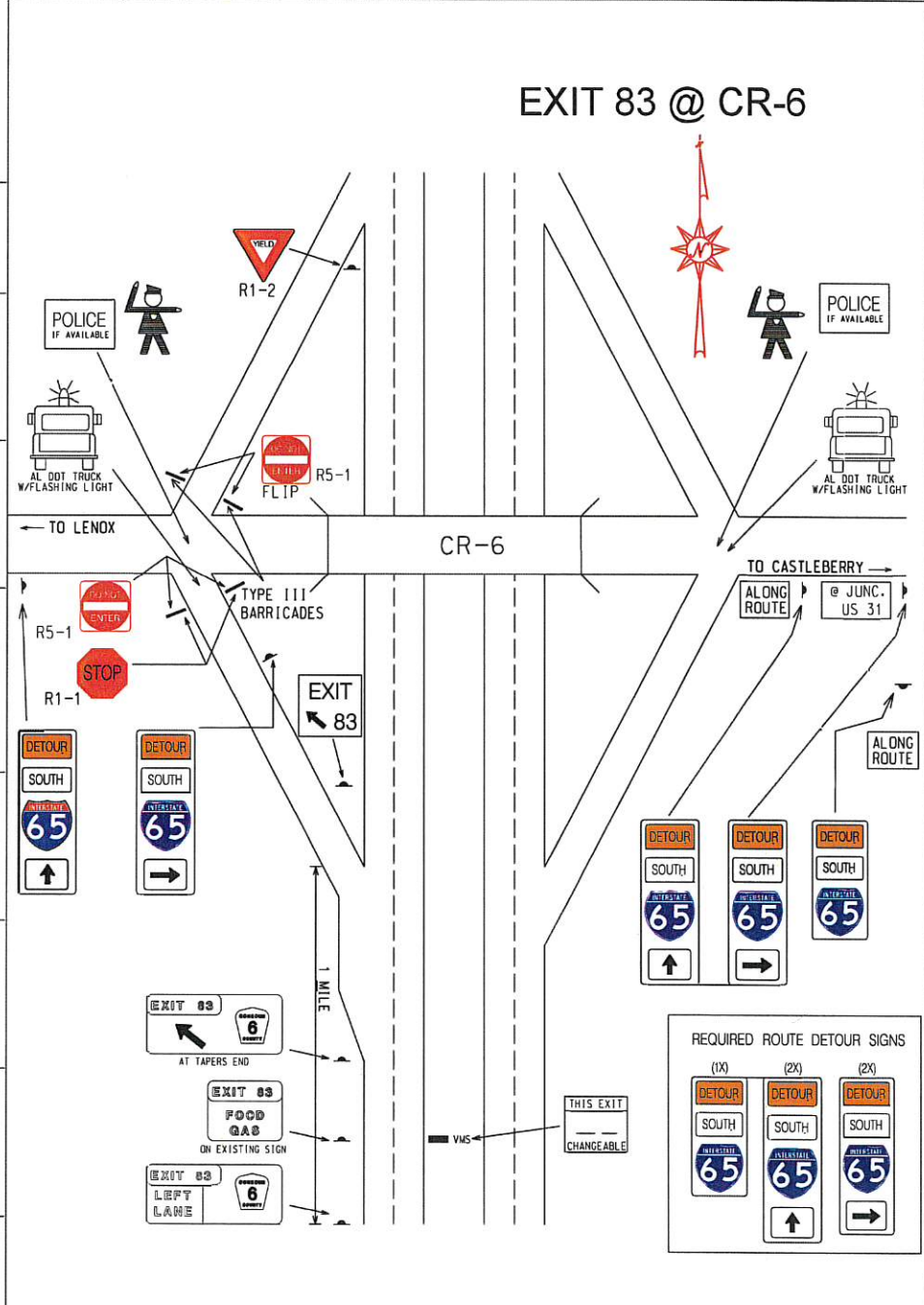

REQUIRED	
2	TYPE III BARRICADES W/STOP SIGNS W/DO NOT ENTER
1	YIELD SIGNS
2	LAW ENFORCEMENT
5	ROUTE DETOUR SIGNS
1	EXIT AHEAD SIGNS
1	EXIT LT. LN. SIGN
1	EXIT SERVICES SIGN
1	EXIT ARROW SIGN

NOTE : COVER ALL INAPPROPRIATE SIGNS