

8 B

SHANE TRIPPANY COOPER CALHOUN

LOCATION	PERSONNEL	CLASS	TRUCK NUMBER	CELL NO.	MISC. EQUIPMENT
Site 8 Exit 57 SR-21	BRUCE HORN	TMT III	ST-18697 PICKUP		
	GEARY MCKELLON	TMT I			W/VMS
	TYRANO JOWERS	TMT II	17919 (VAN)		W/LIGHT BAR
	ABERT MOORE	TMT II			
	DEREK SMITH	TMT II	ST-18408		W/VMS
	MIKE KERLEY	TMT II	ST-14366		
	FRED JOHNSON	TMT I			

22 MOBILE AREA IN PLACE PERSONNEL

23 TL/ATL IN PLACE

26 READY TO IMPLEMENT

30 NOTIFY TL TO BEGIN PROCEDURE

40 ATL ARRIVES AT TYPE B INTERCHANGE

49 ATL ARRIVES AT TYPE B INTERCHANGE

57 ATL'S NB HAVE PASSED

59 INTERCHANGE CLEAR

67 TRAFFIC REVERSED 1ST WAVE

80 1ST WAVE

104 TRAFFIC NORMAL

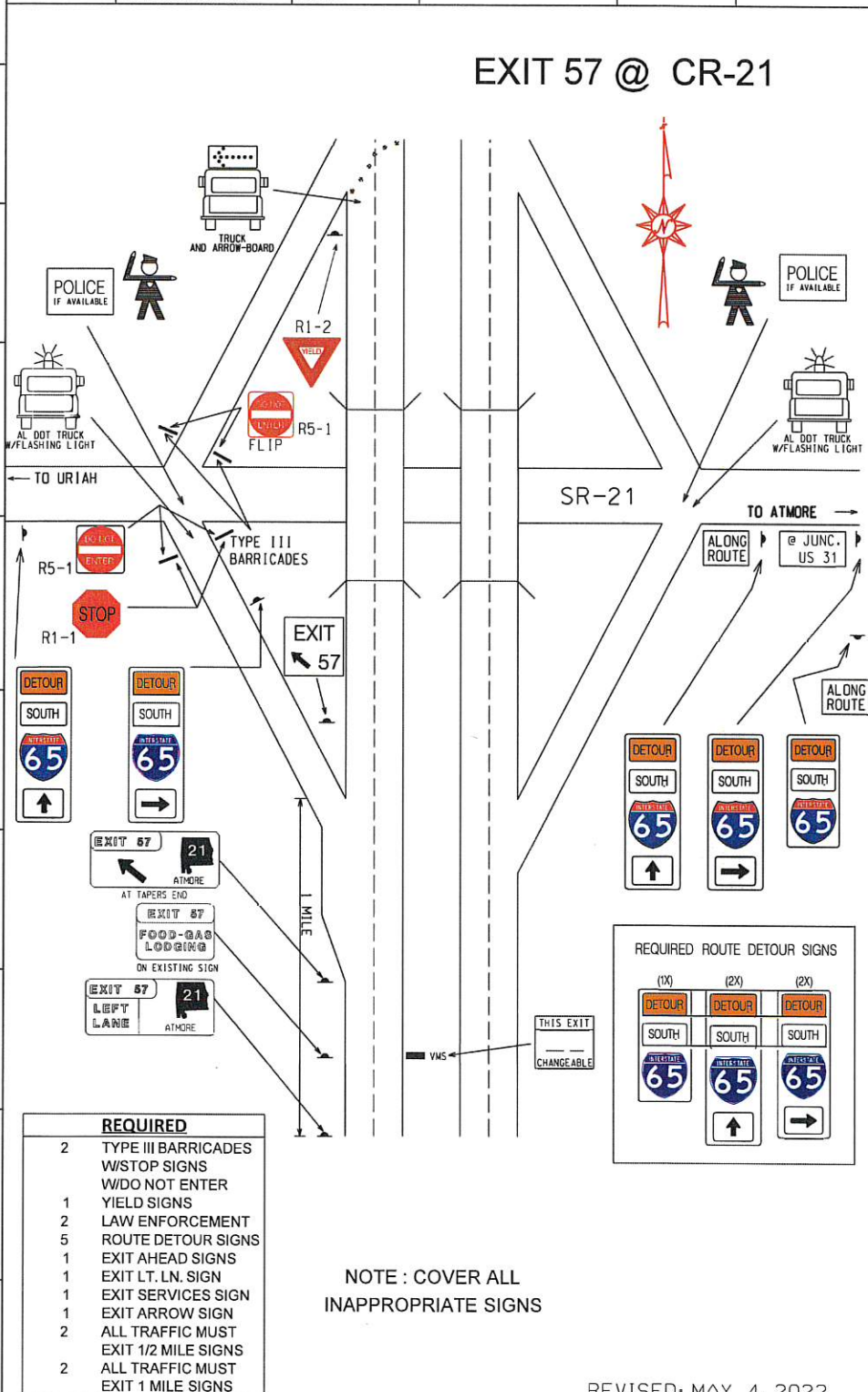

- REQUIRED**
- 2 TYPE III BARRICADES
 - W/STOP SIGNS
 - W/DO NOT ENTER
 - 1 YIELD SIGNS
 - 2 LAW ENFORCEMENT
 - 5 ROUTE DETOUR SIGNS
 - 1 EXIT AHEAD SIGNS
 - 1 EXIT LT. LN. SIGN
 - 1 EXIT SERVICES SIGN
 - 1 EXIT ARROW SIGN
 - 2 ALL TRAFFIC MUST EXIT 1/2 MILE SIGNS
 - 2 ALL TRAFFIC MUST EXIT 1 MILE SIGNS